

PROPOSED  
ASHP

PRIVATE FOOTPATH  
SERVING 1-6 STATION  
COTTAGES AND STATION  
HOUSE

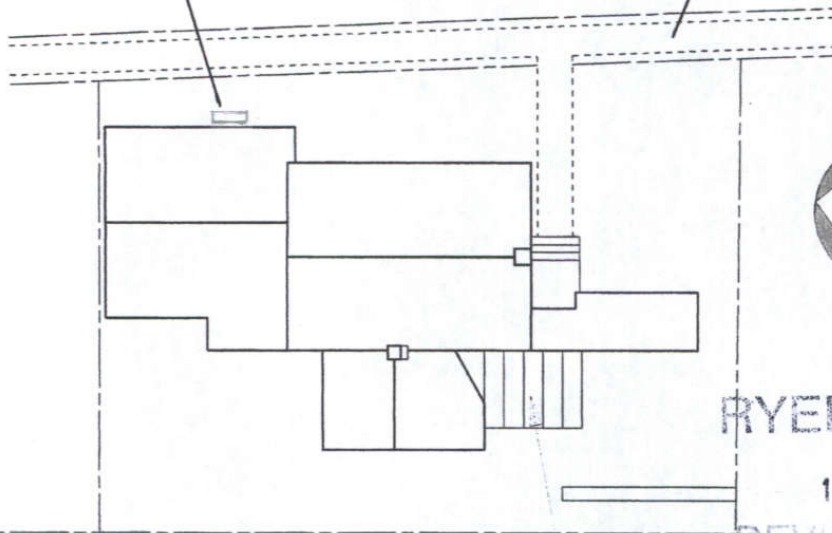

RYEDALE DM

14 APR 2015

DEVELOPMENT  
MANAGEMENT

15/00438/Husa

Block Plan. 1:200.

4 STATION COTTAGES  
HUTTONS AMBO

THIS COPY HAS BEEN MADE BY OR WITH THE  
AUTHORITY OF RYEDALE DISTRICT COUNCIL  
PURSUANT TO SECTION 47 OF THE COPYRIGHT,  
DESIGNS AND PATENTS ACT 1988. UNLESS  
THAT ACT PROVIDES A RELEVANT EXCEPTION TO  
COPYRIGHT, THIS COPY MUST NOT BE COPIED  
WITHOUT THE PRIOR PERMISSION OF THE  
COPYRIGHT OWNER.

**MIKE PUNCHARD  
PLAN DRAWING SERVICE**

9 THE AVENUE, NORTON, MALTON.  
N. YORKS. YO17 9EF  
TEL:- 01653 694276